

# KUMO

## LATERAL ARM CASSETTE SYSTEM

Click here to [watch](#) a promotional video of the Kumo awning.

The **KUMO** awning boasts a smooth round fully enclosed cassette that contains very few components. Suitable for wall or top fix applications and offers control solutions in manual or motorised for ultimate comfort.

Architecturally designed by world renowned European designer, Mario Mazzer, Acmeda's cutting edge KUMO awning combines high performance engineering with state of the art aesthetics.



USE THE CHART BELOW TO GET AN IDEA OF  
WHAT YOUR AWNING COULD COST:

		PROJECTION FROM WALL (APPROX)				
WIDTH		46"	64"	84"	104"	124"
	65"	\$2,420				
	78"	\$2,428	\$2,443			
	93"	\$2,844	\$2,859			
	98"	\$2,873	\$2,887	\$2,945		
	118"	\$2,918	\$2,933	\$2,990	\$3,033	
	138"	\$3,339	\$3,353	\$3,410	\$3,453	\$3,510
	157"	\$3,386	\$3,401	\$3,458	\$3,501	\$3,558
	183"	\$4,491	\$4,504	\$4,562	\$4,604	\$4,661
	196"	\$4,538	\$4,552	\$4,609	\$4,651	\$4,708
	228"	\$4,599	\$4,613	\$4,670	\$4,712	\$4,768
	236"	\$4,613	\$4,627	\$4,683	\$4,725	\$4,781
Minimum Width		55"	75"	94"	114"	134"

\*Prices do NOT include installation or GST

★ Kumo not available with the Quick Pitch Control shoulders or manual override motor

### **MOTORIZATION PRICELIST (Add-on to cost):**

**ALTUS:** Non-manual over-ride motor:

Outside Dotted Borders (35Nm): \$750

Within Dotted Borders (50Nm): \$830

**REMOTE** (starting cost): \$88

**SOMFY WIND/MOTION SENSOR:** \$200



**Awning dimensions with folded arms**

Wall and Ceiling installation (in millimeters)

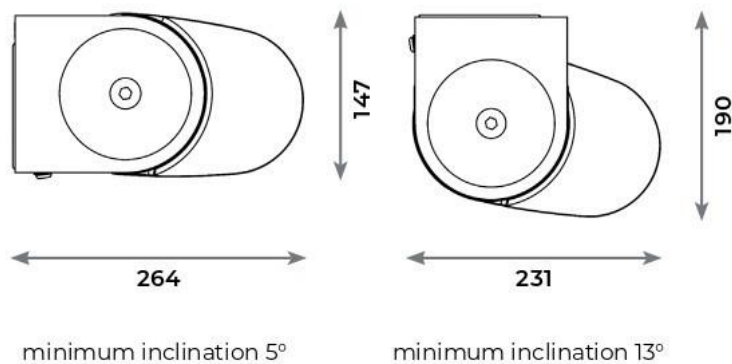

Wall and Ceiling installation (in millimeters)

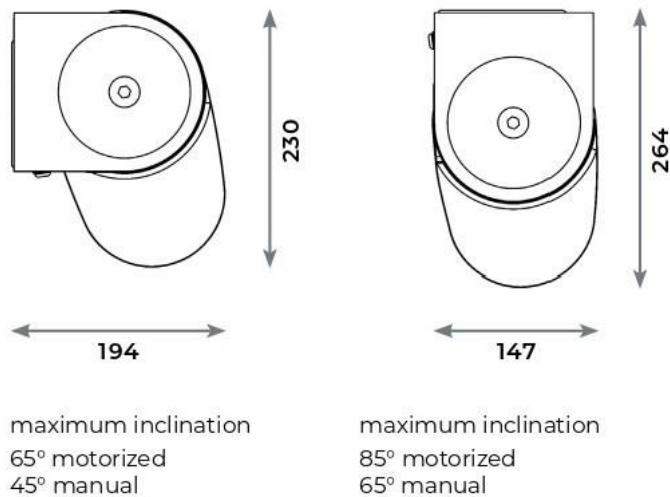

**Arm length and inclination**

65° is the maximum inclination for manual operation.  
85° is the maximum inclination for motorized.

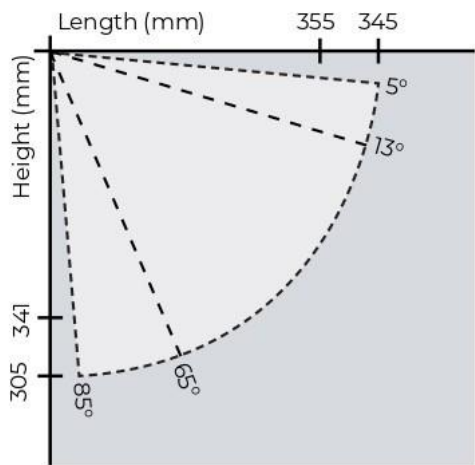

**Bracket dimensions**

Wall or ceiling installation (in millimeters)

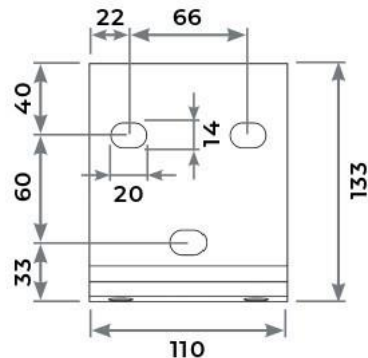

Wall or ceiling installation with Hilti System (in millimeters)

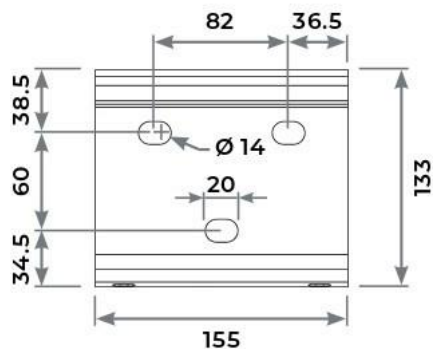

# STEIN

## LATERAL ARM WITH TORSION BAR SYSTEM

The **STEIN** offers a more horizontal compact finish best suited for installation under roof eaves. Achieving spans up to 14m with a class performing Dynamic Arm Torsion system, these superior shade products are certified to withstand winds up 50km/h. An optional hood ensures fabric protection and longevity.

The Stein awning comes in a contemporary colour range to combine exceptional sun protection with a modern design which will complement any existing outdoor décor.



★ The Stein front bar has an exclusive drip rail at front bar for rain!



### OPTIONAL HOOD:

1 piece hood is easy to install and has a gasket at the back to help protect the fabric. Note: No end caps available.

## USE THE CHART BELOW TO GET AN IDEA OF WHAT YOUR AWNING COULD

	PROJECTION FROM WALL (APPROX)							
		46"	64"	84"	104"	124"	143"	HOOD
WIDTH	65"	\$1,873						
	78"	\$1,937						
	91"	\$2,000	\$2,054					
	93"	\$2,019	\$2,072					\$419
	98"	\$2,121	\$2,195					\$419
	118"	\$2,266	\$2,340	\$2,451				\$508
	★ 137"	\$2,344	\$2,417	\$2,529	\$2,627			\$574
	138"	\$2,437	\$2,511	\$4,717	\$2,721			\$574
	157"	\$2,535	\$2,628	\$2,759	\$2,877	\$3,008		\$639
	★ 183"	\$3,017	\$3,109	\$3,239	\$3,357	\$3,486	\$3,703	\$772
	196"	\$3,130	\$3,243	\$3,392	\$3,505	\$3,654	\$3,916	\$772
	228"	\$3,900	\$4,011	\$4,160	\$4,266	\$4,414	\$4,647	\$1,080
	275"	\$4,012	\$4,144	\$4,283	\$4,437	\$4,572	\$4,293	\$1,080
	WITH JOINS							
	315"	\$4,675	\$4,823	\$5,006	\$5,177	\$5,360	\$5,627	\$1,278
	318"	\$5,170	\$5,318	\$5,501	\$5,673	\$5,856	\$6,122	\$1,410
	354"	\$5,242	\$5,407	\$5,608	\$5,798	\$5,999	\$6,283	\$1,410
	363"	\$5,401	\$5,565	\$5,765	\$5,952	\$6,152	\$6,434	\$1,544
	393"	\$5,469	\$5,651	\$5,868	\$6,073	\$6,290	\$6,589	\$1,544
Minimum Width		63"	82"	102"	122"	142"	162"	

\*Prices do NOT include installation or GST

★ 137" wide is efficient for 3 panels of fabric (46") and is also efficient for hardware. 183" wide is efficient for 4 panels of fabric.

### MOTORIZATION PRICELIST

#### (Add-on to cost):

**ALTUS:** Non-manual over-ride motor:

Outside Dotted Borders (35Nm): \$750

Within Dotted Borders (50Nm): \$830

**CMO:** Manual over-ride motor:

Outside Dotted Borders (35Nm): \$915

Within Dotted Borders (50Nm): \$975

**REMOTE** (starting cost): \$88

**SOMFY WIND/MOTION SENSOR:** \$200

## STEIN Lateral Arm with Torsion Bar



### Awning dimensions with folded arms

Wall or ceiling installation (in millimeters)

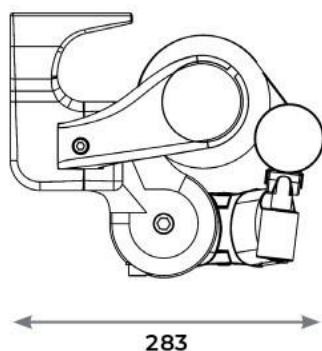

minimum inclination 5°

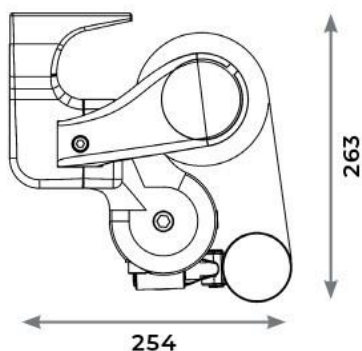

maximum inclination 85°

### Arm length and inclination

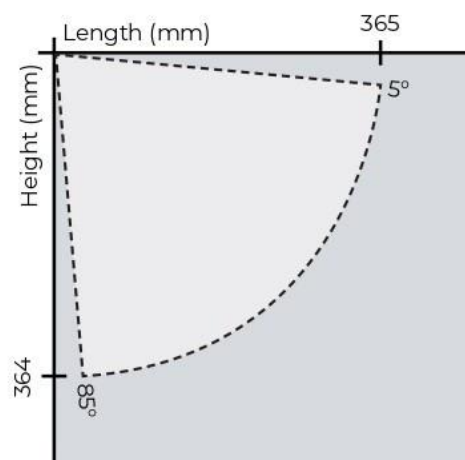

### Bracket dimensions

Wall installation (in millimeters)

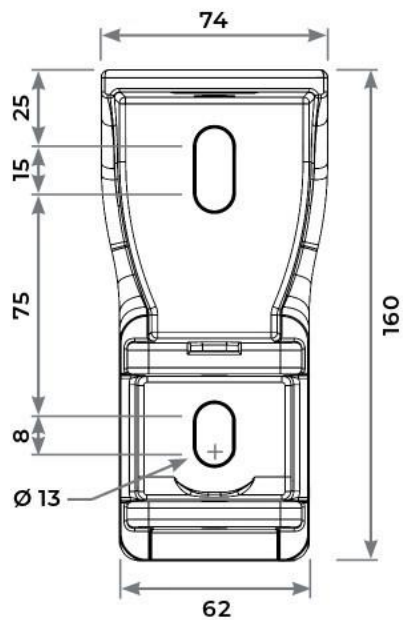

Ceiling installation (in millimeters)

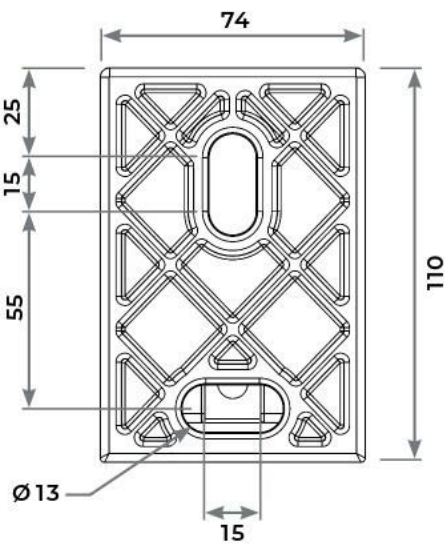



## SOMFY MOTORIZATION



- Radio Remote Control Motor Systems
- Somfy Altus RTS series is the best quality radio remote control motors on the market.
- These motors can be activated with a remote-control hand unit or with a radio sender wall switch that mounts inside the house like a regular switch but uses radio waves to activate the awnings eliminating the need for additional wiring. Controllers are available to operate more than 1 awning from a single controller.
- The manual override motors are a must in case of power outages or other mishaps, as without this feature you will not be able to bring in the awning in a wind storm or heavy snow (Not available on the Kumo).

**CHECK OUT THESE LINKS TO LEARN MORE:**

<https://www.youtube.com/watch?v=9kAobHnKub8>

### Wind Control Option

Whether you are home or away you can sit back, relax and not worry about the weather. A wind sensor will automatically retract your awning in the event of high winds. You don't have to rush home or deal with a cumbersome hand crank to retract your awning in windy conditions. The wind sensor is a radio transmitter and is available only for the radio control motors (Altus RTS, RTS CMO, Orea RTS).

Eolis WireFree™ RTS Wind/Motion Sensor a very accurate measure of how much wind motion is effecting the awning.



*Somfy is the world leader in motors and controls for openings.*

# AWNING FABRIC SEAM WELDING SYSTEM

---

Used for many years in Europe, this state-of-the-art awning fabric seam joining system is now available in Canada. SunStopper™ Awnings are the first major awning manufacturer in Canada to incorporate this state-of-the-art fabric adhesive technology. All seams and hems, with the exception of the header rod seams, are bonded. The header rod seam is sewn using PTFE thread.



## Stronger Seams and Hems

The bonded seams are stronger than the surrounding fabric. The fabric will rip before the seam will fail.

## Proven Durability

The harsh cold of Canadian winters does not effect the seam strength.

## Less Visible Seams and Hems

Without the use of thread, welded seams are almost invisible. Threads can never quite match all the colour variations in stripe fabrics, with welding this is no longer a concern.

## Flatter Seams and Hems

With bonded seams there is less sag created by seam thickness.

## Reduced Fabric Fraying

The fabric is cut using ultrasonic cutters and is further sealed during the bonding process.

## Less Leakage

With bonded seams there are no holes in the fabric caused by the sewing needles.



State-of-the Art Bonded Seam

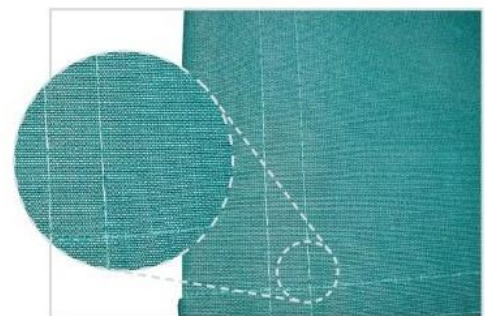

Traditional Sewn Side Hem

# HEAVY DUTY ARMS & COLOURS

MADE IN ITALY

## Heavy Duty Arms

Stein and Kumo have heavy duty arms with a stainless steel triplex chain that won't stretch and brass bushings at the shoulder joint. Arms that are engineered to last.

## Colours

All frames available in either Matte White or Graphite.



Stainless Steel  
Triplex Chain

Graphite  
Frame

Matte White  
Frame

VS



Other manufacturers use arms with cables that can stretch and break.

# AWNING WARRANTY



**\*Best Frame Warranty  
in the Business!**

## Sun Stopper Awnings™ 10 Year Limited Warranty

George N. Jackson Limited warrants to the original purchaser only, its retractable Sun Stopper Awning™ and Sunstopper Drop Shade™ frames to be free from defects in material and workmanship under normal and proper use for a period of (10) ten years commencing from the date of purchase on all awnings purchased after January 1, 2015. The standard manufacturer's warranties for fabric, motors and other optional equipment are not covered by this limited warranty. Any defects in the hardware must be reported within (10) ten years of the date of purchase accompanied with proof of purchase to an authorized Sun Stopper dealer. Under this warranty, George N. Jackson has the option to repair or replace those parts deemed defective.

This limited warranty does not cover defects caused by improper installation, reinstallation, service, or failure to operate pitch control mechanisms correctly. George N. Jackson Limited is not responsible for normal wear and tear, damage caused by misuse, and acts of nature such as wind damage, rain build up on the fabric, snow build up on the frame or fabric, hail, fire or vandalism. Labour cost for the removal and reinstallation of any awning components are not covered by this warranty and are the responsibility of the owner. Any defective part must be returned to an authorized Sun Stopper™ dealer for return to George N. Jackson Limited. George N. Jackson Limited shall not be liable for any incidental or consequential damages, loss or injury. This warranty gives you specific legal rights, but you may also have additional rights as per provincial statutes.

# FABRIC WARRANTY



**recacril®**  
DESIGN LINE

## Recacril® Warranty

RECASENS guarantees the Recacril® canvas for a period of 10 years from the date of installation.

The guarantee covers the abnormal deterioration, decay and loss of color of Recacril® subjected to normal atmospheric conditions and when correct maintenance has been systematically carried out. Within the period, RECASENS will replace free of charge the defective yardage or pay its cost. The guarantee covers only the value of the canvas and specifically excludes any other elements of the awning (hardware, mechanisms, etc.), as well as the costs of producing and installing the awning. The warranty does not cover any deterioration due to abuse, negligence, vandalism, burns of any kind, fires and natural disasters.

In particular, the warranty does not cover:

- The lack of maintenance of the canvas during its use.
- Use of inappropriate cleaning solutions or tools. NEVER use solvents, stiff bristle brushes or other scraping instruments that can damage the fabric or its protective finish.
- Atmospheric pollution or plant herbicides.
- Animal waste.
- Improper installation of the fabric, or misuse by the customer.
- Placing objects, or items falling, on the top of the canvas.
- Unusual atmospheric conditions (lightning, storms, etc.).

In order to process the guarantee, it is necessary to contact the installer or distributor from whom you purchased the product. The installer or distributor shall forward the claim to RECASENS. Replacement or refund of defective fabric does not imply the extension of the warranty of the replacement fabric.

\*For products installed on or after November 1st, 2013, Recacril awning and marine fabrics will be covered for a period of ten years from the date of original installation. For approved claims Recasens USA will provide 100% of the replacement fabric required at no cost for years one through seven of the warranty period. In the eighth year Recasens will supply 50% of the replacement fabric at no cost. In the ninth year Recasens USA will supply 30% of the replacement fabric at no cost. In the tenth year Recasens USA will provide 15% of the replacement fabric at no cost.

**RECASENS USA**  
BCN 1886

# MOTORIZATION WARRANTY

SOMFY warrants its motors to be free from defects in material and workmanship under normal and proper use for a period of five years starting from the date stamped on the motor. Drapery motors, mechanical, electrical and electronic accessories (excluding batteries) are warranted for five years from date of invoice



**OUR DISPLAYS ARE AVAILABLE TO BE VIEWED AT:**

**George N Jacksons**

**600 Derwent way, Delta**

**Monday – Friday (closed on weekends)**

George N Jacksons have been a family owned business based in Winnipeg since 1919.



**STEIN**



**KUMO**